

PROJECT	QUANTITY	ITEM NO
---------	----------	---------

Heated merchandisers

Full-serve or self-serve

MODEL **HMR-103**
3 well



3-well heated merchandiser, model HMR-103 shown as full-serve unit.

General Information

Henny Penny HMR heated merchandisers are designed to provide the ultimate in flexibility and performance for displaying and serving fresh hot foods. The HMR series is a modular system that lets the operator choose the size, style and configuration of full-serve and self-serve heated modules.

The HMR-103 merchandiser can be ordered as either full-serve or self-serve. In addition, four different front glass profiles are available to help you match existing cases.

All full-serve modules feature Henny Penny's unique THERMA-VEC® Even Heat Process that holds food at precise temperatures and

keeps glass from fogging for a more appetizing display. Upper and lower heating is independently controlled.

Merchandiser bases are available in Profile or Pedestal styles in several heights and colors. (See separate Data Sheet.)

Standard Features

- Stainless steel interior and exterior construction, tempered front and side panel glass and doors.
- Choose from four glass profiles:
 - Henny Penny curved
 - Henny Penny straight
 - Vision (matches Hussmann Vision® series)
 - Advantage (matches Tyler Advantage® series.)
- Exclusive THERMA-VEC® Even Heat Process holds food at precise temperatures with no fogging.
- Independent controls over each well for upper radiant heat and food probe temperature display.
- Lower heat and water pan heat independently controlled.
- Control settings can be locked to prevent accidental changes.
- Humidified operation with built-in low-water indication.
- Separate switches for power and lights.
- Brilliant halogen lamps for attractive food presentation.
- Front glass lifts easily for cleaning and closes gently on gas springs.
- Mirrored or clear side glass. (CE units are only available with clear side glass.)
- Removable sliding rear doors with mirrored glass.
- Fold-down wood or plastic cutting board.
- Units are shipped with adjustable pan supports, food temperature probes, and a water pan.

Accessories available separately

- Modular system of wire shelves and guide rails that offer "two-tier" capacity for various HMR configurations:
 - Wire shelf—three-well section
 - Wire shelf—two-well section
 - Pan support with guide rail

<input type="checkbox"/> APPROVED	<input type="checkbox"/> APPROVED AS NOTED	<input type="checkbox"/> RESUBMIT
AUTHORIZED SIGNATURE		DATE



Henny Penny Corporation
PO Box 60 Eaton OH 45320 USA
+1 937 456.8400 800 417.8417
+1 937 456.8434 Fax 800 417.8434 Fax
www.hennypenny.com

PROJECT

ITEM NO

Heated merchandisers

Full-serve or self-serve

MODEL **HMR-103**
3 well

Available glass profiles:

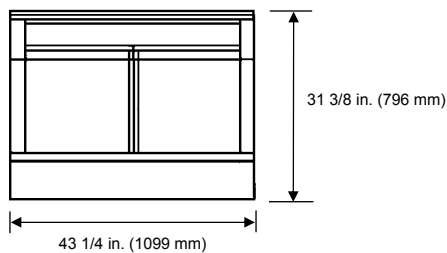
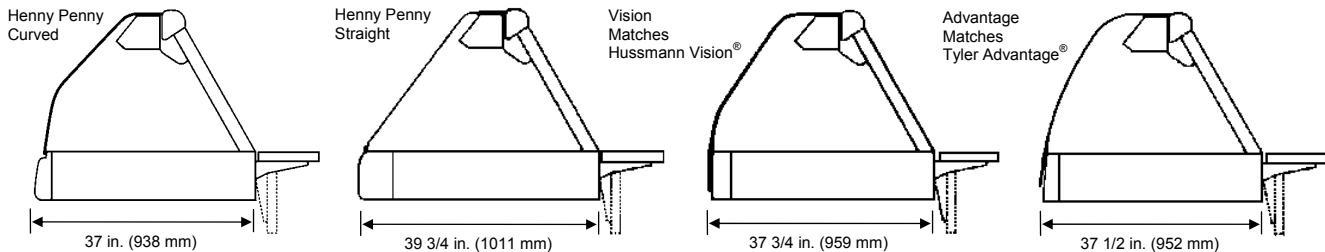

Dimensions

Length: 43 1/4 in. (1099 mm)
 Depth: 37 in. (938 mm) Henry Penny Curved
 39 3/4 in. (1011 mm) Henry Penny Straight
 37 3/4 in. (959 mm) Hussmann Vision
 37 1/2 in. (952 mm) Tyler Advantage
 Height: 31 3/8 in. (796 mm)

Required clearances

Top: 15 in. (381 mm) for raised front glass.
 Back: 9 in. (229 mm) for cutting board

Crated dimensions

Length: 49 3/4 in. (1264 mm)
 Depth: 48 3/4 in. (1238 mm)
 Height: 40 in. (1016 mm)
 Volume: 56 cu. ft. (1.57m³)

Crated weight 361 lbs. (164 kg). May vary with selections.

Capacity

Full-serve Per well
 (1) full-size pan
 (1) third-size pan up to 4 in. (102 mm) depth.
 Self-serve Insert
 3-well area 26 3/4 x 37 3/4 in. (679 x 959 mm)
 Specify depth: Flat, 3/8 in. (10 mm), or 2 in. (51 mm)

Laboratory certifications



Electrical: All units are 50/60 Hz.

Configuration	Volts	Phase	Low Watts/Amps		High Watts/Amps		Wire
			Watts	Amps	Watts	Amps	
<input type="checkbox"/> 3S 	120/208	1	2415	11.6	3165	15.2	3+G
	120/240	1	2415	10.1	3301	13.8	3+G
	220-240	1	2761	11.5	3647	15.2	2+G
	120/208	3	2415	9.2	3165	11.1	4+G
	120/240	3	2415	8.1	3301	10.1	4+G
<input type="checkbox"/> 3F 	380-415	3	2761	5.4	3647	6.1	3NG
	120/208	1	2991	14.4	3741	18.0	3+G
	120/240	1	3026	12.6	3912	16.3	3+G
	220-240	1	3373	14.1	4259	17.7	2+G
	120/208	3	2991	9.8	3741	11.8	4+G
120/240	3	3026	8.7	3912	10.7	4+G	
380-415	3	3373	5.4	4259	6.8	3NG	

Power cord and plug included for Canada or USA destination:

120/208V 1Ph
 120/240V 1Ph

NEMA L14-30P



120/208V 3Ph

NEMA L21-20P



All other electrical configurations must be hardwired at installation.

Bidding Specifications See separate page

Continuing product improvement may subject specifications to change without notice.

HENNY PENNY
Global Foodservice Solutions

www.hennypenny.com